

MAP RECORD	
FIELD DATA OBTAINED IN 2000	
FIELD EXAMINATION MADE IN	
REVISIONS	
FEATURE	DATE

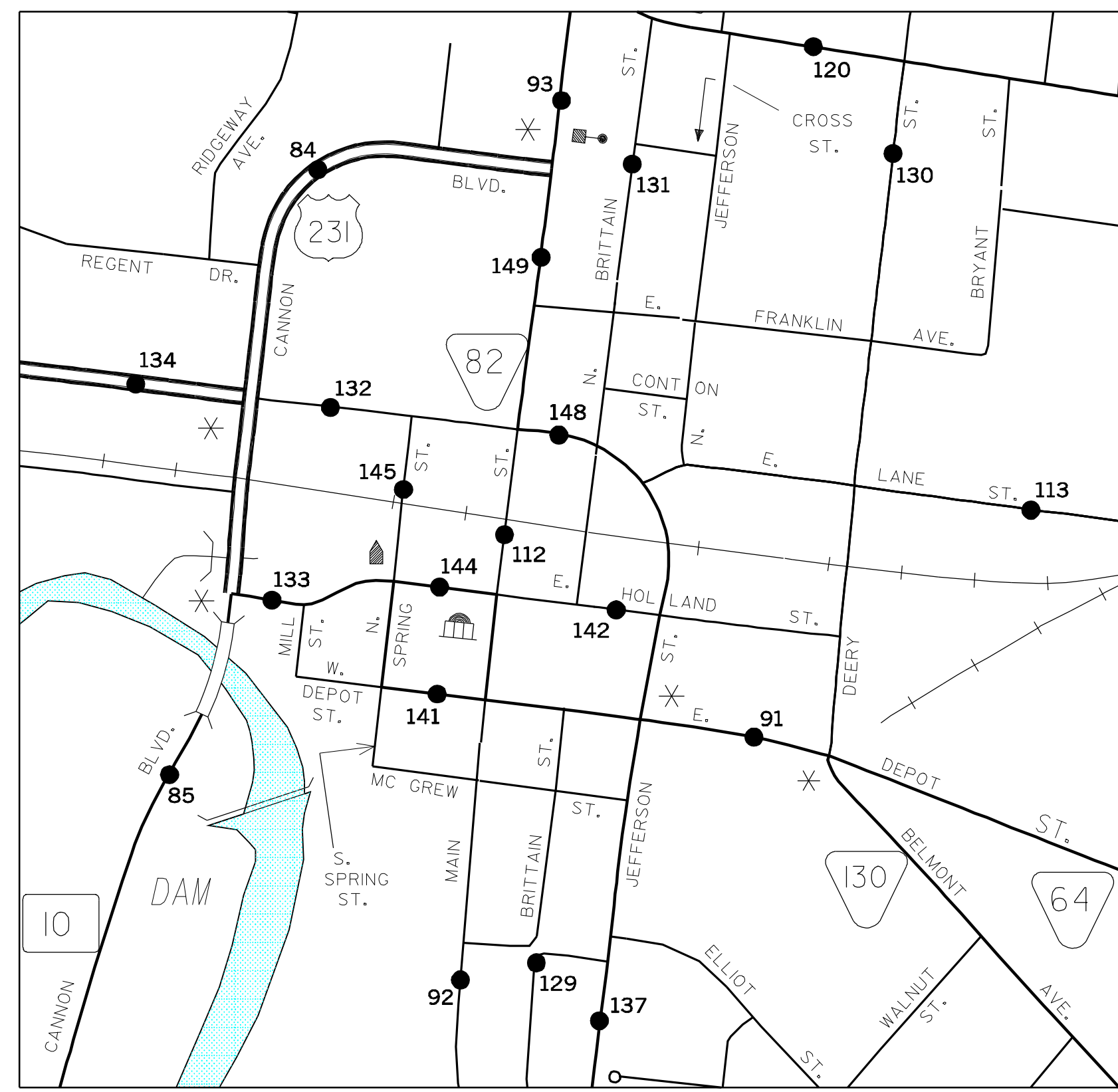

**SHELBYVILLE C.B.D. INSET**



**LEGEND**

- SCHOOL
- HOSPITAL
- POST OFFICE
- COURT HOUSE
- CITY HALL OR COMMUNITY CENTER
- MONUMENT
- AIRPORT, COMPLETE FACILITIES
- AIRPORT, LIMITED FACILITIES
- LANDING AREA OR STRIP
- POWER PLANT
- WEIGHT STATION
- HIGHWAY GARAGE (S-STATE, C-COUNTY)
- POINTS OF INTEREST
- INTERSTATE HIGHWAY MARKER
- U.S. NUMBERED HIGHWAY MARKER
- STATE HIGHWAY MARKER
- FEDERAL AID PRIMARY SYSTEM
- STATE HIGHWAY MARKER
- FEDERAL AID SECONDARY SYSTEM
- LAKE WITH DAM
- RESERVOIR, POND OR LAKE
- LEVEE OR DYKE
- NARROW STREAM
- WIDE STREAM
- DAM WITH LOCK
- HEAD OF NAVIGATION
- NAVIGABLE STREAM
- GRADE CROSSING
- UNDERPASS-ROAD BELOW
- OVERHEAD-ROAD ABOVE
- RAILROAD TUNNEL
- GRADE SEPARATION
- FORD
- LOW WATER BRIDGE
- FREE FERRY OR TOLL FERRY
- HIGHWAY BRIDGE-OVER 20 FEET
- HIGHWAY BRIDGE-LONG RIVER CROSSING (C-CONCRETE, S-STEEL, W-WOOD)
- PRIMITIVE OR UNIMPROVED ROAD
- GRADED AND DRAINED, SOIL, GRAVEL OR STONE SURFACED ROAD
- PAVED ROAD
- GRADED AND DRAINED, SOIL, GRAVEL OR STONE SURFACED HIGHWAY
- PAVED HIGHWAY
- DIVIDED ROADWAY
- DISTANCE IN MILES BETWEEN DESIGNATED POINTS
- (FCAI) FULL CONTROL OF ACCESS
- (NPS) NATIONAL PARK SERVICE HIGHWAY
- COUNTY LINE
- STATE LINE
- INCORPORATED CITY BOUNDARY
- RESERVATION BOUNDARY

LEGEND  
 STATION NUMBER ● 143  
 A.A.D.T. (ANNUAL AVERAGE DAILY TRAFFIC)

NOTES  
 STATION NUMBERS ON SHELBYVILLE CITY MAP  
 36-38-39-40-41-42-54-55-57-83-84-85-88-89-90-91-  
 92-93-94-95-103-104-105-106-107-108-109-110-111-112-  
 113-114-115-116-117-120-121-122-128-129-130-131-132-  
 133-134-135-137-140-141-142-144-145-147-148-149

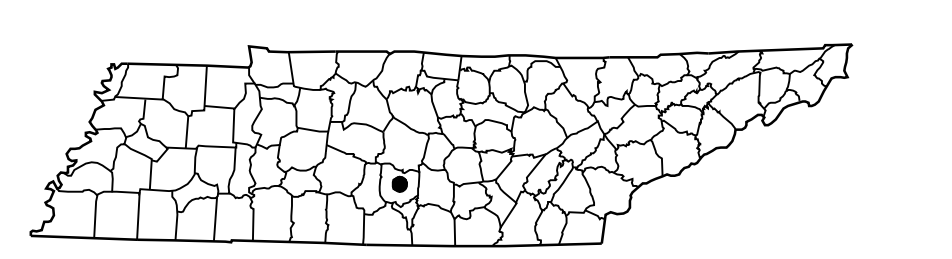
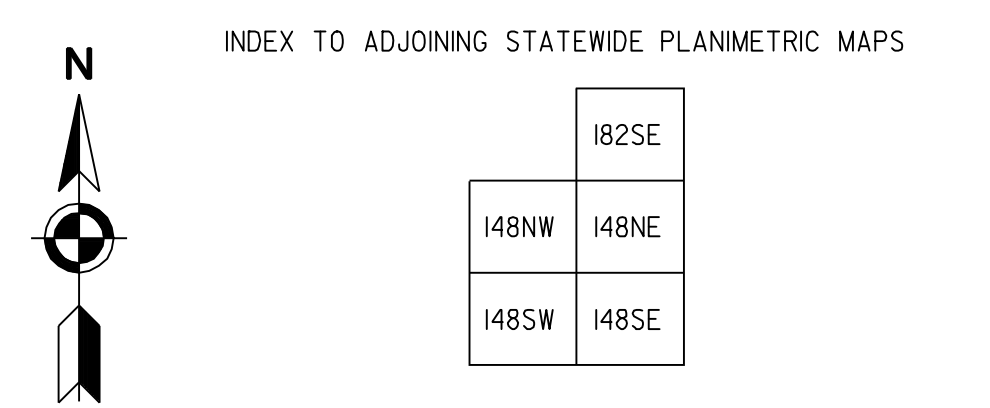

**2010 TRAFFIC MAP**  
**SHELBYVILLE**  
 BEDFORD COUNTY  
 TENNESSEE

PREPARED BY THE  
 TENNESSEE DEPARTMENT OF TRANSPORTATION  
 LONG RANGE AND PROJECT PLANNING DIVISIONS  
 IN COOPERATION WITH THE  
 U.S. DEPARTMENT OF TRANSPORTATION  
 FEDERAL HIGHWAY ADMINISTRATION

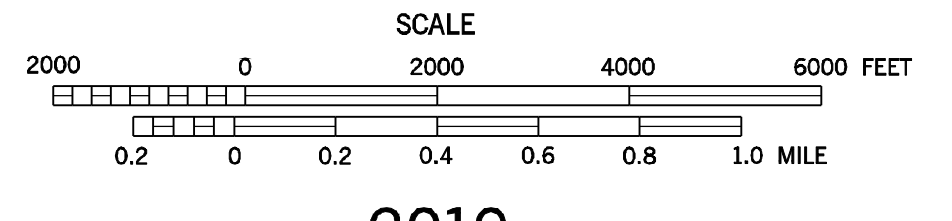

2010

AUTHORIZATION NO. 4090020250

COUNTY	STATION NUMBER	YEAR	AADT
2	000002	2010	3469
2	000003	2010	1071
2	000004	2010	929
2	000005	2010	4727
2	000006	2010	2474
2	000007	2010	1105
2	000009	2010	904
2	000010	2010	678
2	000012	2010	14553
2	000015	2010	1174
2	000016	2010	1376
2	000017	2010	2218
2	000019	2010	1576
2	000020	2010	389
2	000021	2010	409
2	000022	2010	1991
2	000023	2010	1400
2	000024	2010	2709
2	000027	2010	1235
2	000029	2010	495
2	000030	2010	1542
2	000031	2010	747
2	000032	2010	1186
2	000033	2010	2859
2	000036	2010	15917
2	000038	2010	1772
2	000039	2010	2733
2	000040	2010	26527
2	000041	2010	9076
2	000042	2010	4395
2	000047	2010	774
2	000048	2010	3064
2	000052	2010	5017
2	000053	2010	2551
2	000054	2010	7532
2	000055	2010	6022
2	000057	2010	4355
2	000058	2010	9746
2	000059	2010	990
2	000061	2010	599
2	000063	2010	1189
2	000065	2010	419
2	000068	2010	3256
2	000071	2010	600
2	000073	2010	1839
2	000074	2010	812
2	000075	2010	355
2	000076	2010	751
2	000077	2010	2181
2	000078	2010	326
2	000080	2010	497

2	000081	2010	323
2	000083	2010	6358
2	000084	2010	8774
2	000085	2010	17769
2	000086	2010	773
2	000087	2010	845
2	000088	2010	11819
2	000089	2010	7567
2	000090	2010	17030
2	000091	2010	7715
2	000092	2010	1022
2	000093	2010	14302
2	000094	2010	4382
2	000096	2010	6535
2	000097	2010	82
2	000098	2010	319
2	000099	2010	513
2	000101	2010	623
2	000102	2010	176
2	000103	2010	1286
2	000104	2010	2342
2	000105	2010	2242
2	000106	2010	3852
2	000107	2010	3573
2	000108	2010	4762
2	000109	2010	2052
2	000110	2010	691
2	000111	2010	4760
2	000112	2010	2653
2	000113	2010	4945
2	000114	2010	2196
2	000115	2010	555
2	000116	2010	2846
2	000117	2010	2564
2	000118	2010	6741
2	000119	2010	2721
2	000120	2010	17269
2	000121	2010	9955
2	000122	2010	128
2	000124	2010	2797
2	000125	2010	1300
2	000126	2010	787
2	000127	2010	3487
2	000128	2010	1990
2	000129	2010	168
2	000130	2010	4423
2	000131	2010	1458
2	000132	2010	13643
2	000133	2010	4340
2	000134	2010	10591
2	000135	2010	8077
2	000137	2010	4512

2	000138	2010	1970
2	000139	2010	173
2	000140	2010	820
2	000141	2010	2950
2	000142	2010	1011
2	000144	2010	4444
2	000145	2010	1186
2	000146	2010	429
2	000147	2010	16703
2	000148	2010	13410
2	000149	2010	8460
2	000150	2010	805
2	000151	2010	14409
2	000152	2010	3367