

180000 FT 170000 FT 172000 FT 174000 FT 176000 FT 178000 FT 180000 FT 182000 FT 184000 FT 186000 FT 188000 FT 190000 FT

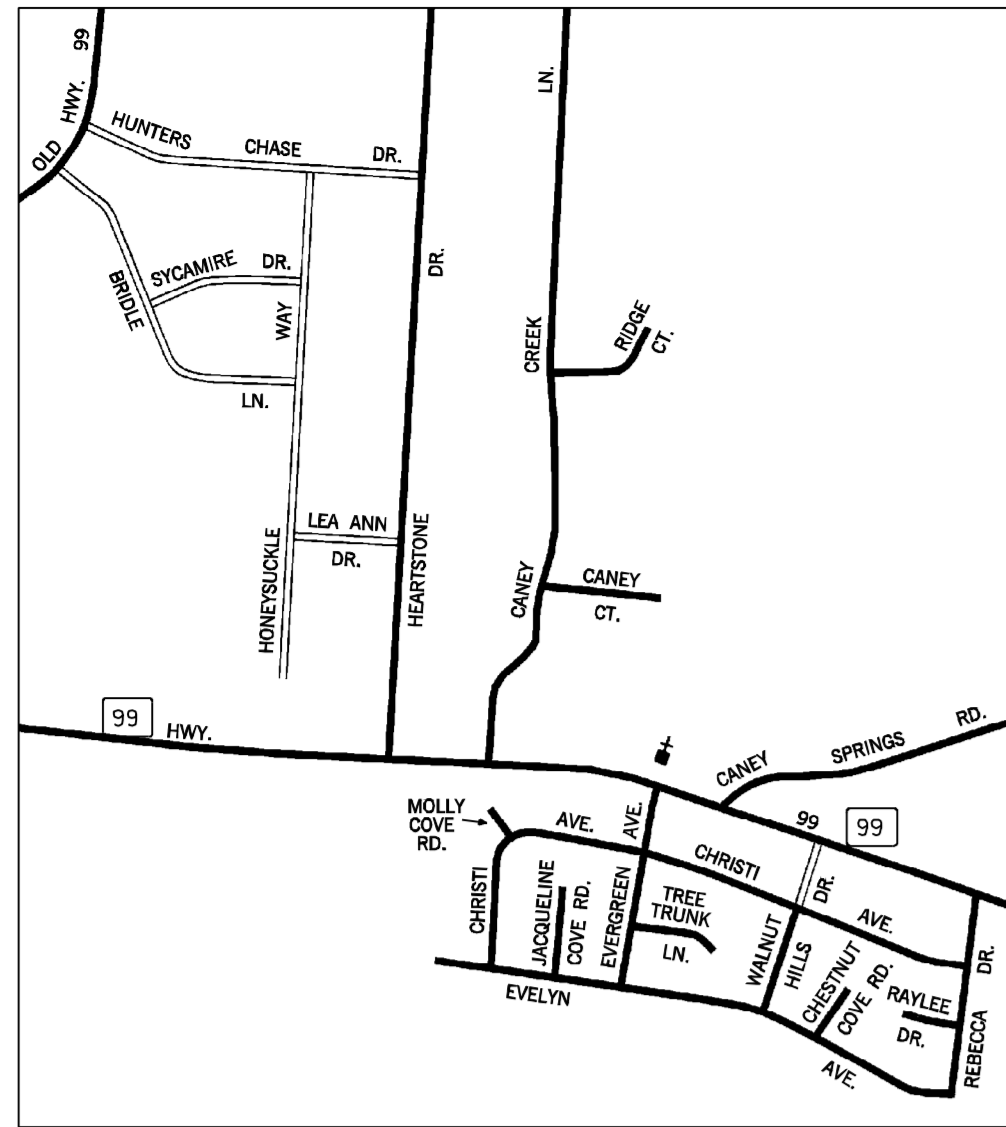

AREA EAST OF CANCY SPRING
1

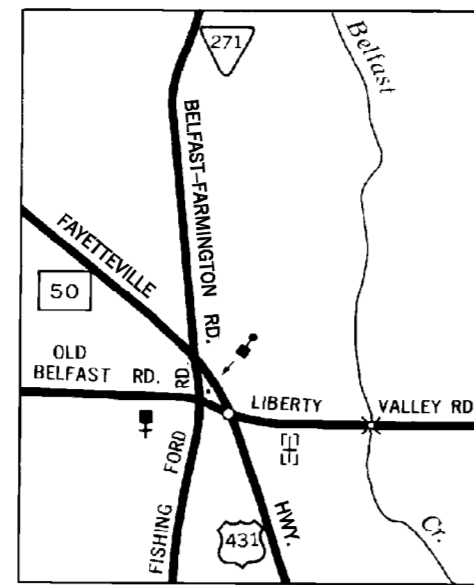

BELFAST
2

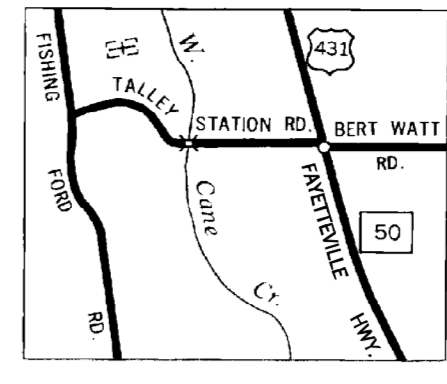

TALLEY
3

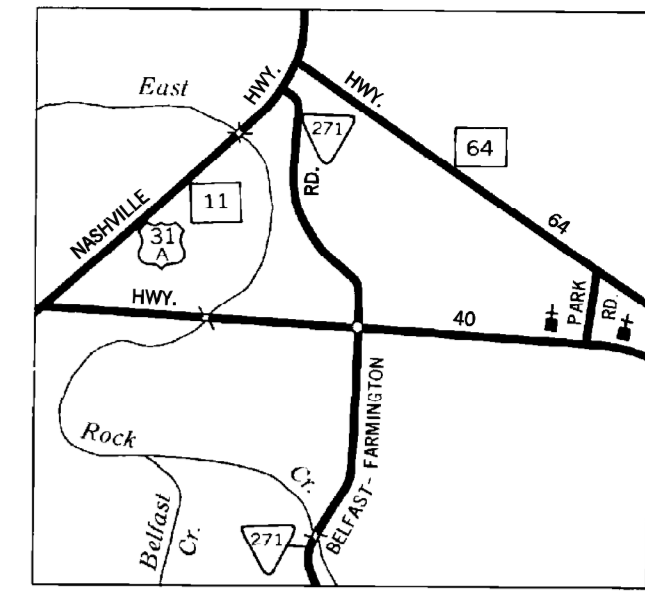

FARMINGTON
4

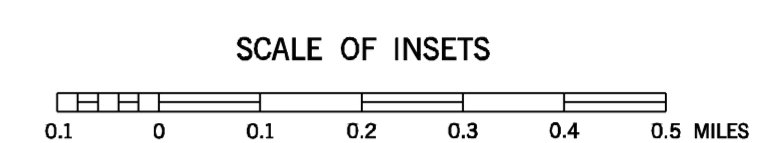

LEGEND

- SCHOOL
- CHURCH
- CHURCH WITH CEMETERY
- CEMETERY
- HOSPITAL
- POST OFFICE
- CITY HALL OR COMMUNITY CENTER
- MONUMENT
- AIRPORT - COMPLETE FACILITIES
- AIRPORT - LIMITED FACILITIES
- LANDING AREA OR STRIP
- HIGHWAY GARAGE (S-STATE, C-COUNTY)
- TRANGLATION STATION
- OBSERVATION OR LOOKOUT TOWER
- COUNTY SEAT
- OTHER CITIES AND VILLAGES
- RADIO OR TELEVISION STATION
- POINT OF INTEREST
- DOT TO INDICATE LOCATION OF ANY CULTURAL FEATURE OUT OF PLACE
- INTERSTATE HIGHWAY
- U S NUMBERED HIGHWAY
- STATE HIGHWAY
- STATE HIGHWAY
- PROMINENT PEAK WITH ELEVATION
- LAKE WITH DAM
- RESERVOIR, POND OR LAKE
- LEVEE OR DYKE
- DRAINAGE CANAL
- NARROW STREAM
- WIDE STREAM
- DAM WITH LOCK
- HEAD OF NAVIGATION
- NAVIGABLE STREAM
- GRADE CROSSING
- UNDERPASS-ROAD BELOW
- OVERHEAD-ROAD ABOVE
- RAILROAD TUNNEL
- GRADE SEPARATION
- FORD
- LOW WATER BRIDGE
- FREE FERRY OR TOLL FERRY
- HIGHWAY BRIDGE-OVER 20 FEET
- HIGHWAY BRIDGE-LONG RIVER CROSSING
- PRIMITIVE OR UNIMPROVED ROAD
- GRADED AND DRAINED SOIL, GRAVEL OR STONE SURFACED ROAD
- PAVED ROAD
- PAVED HIGHWAY OR ROAD
- DIVIDED ROADWAY
- DISTANCE IN MILES BETWEEN DESIGNATED POINTS
- FULL CONTROL OF ACCESS
- NATIONAL PARK SERVICE HIGHWAY
- HIGHWAY INTERCHANGE
- COUNTY LINE
- STATE LINE
- INCORPORATED CITY BOUNDARY
- RESERVATION BOUNDARY
- PAVED OR GRAVEL PUBLIC ROAD
- MAINTENANCE NOT CITY OR COUNTY RESPONSIBILITY

LEGEND

- STATION NUMBER ● 62
- A. A. D. T. 1010
- (ANNUAL AVERAGE DAILY TRAFFIC)

NOTES

HIGHEST STATION NUMBER FOR THIS COUNTY - 133

STATION NUMBERS ON MARSHALL COUNTY MAP
 1-2-3-4-5-8-9-10-12-13-14-16-19-20-23-
 24-27-33-40-41-42-43-44-46-49-50-51-52-53-
 54-55-59-63-64-68-69-70-71-80-81-82-
 84-86-87-88-89-92-93-96-120-127-129-130

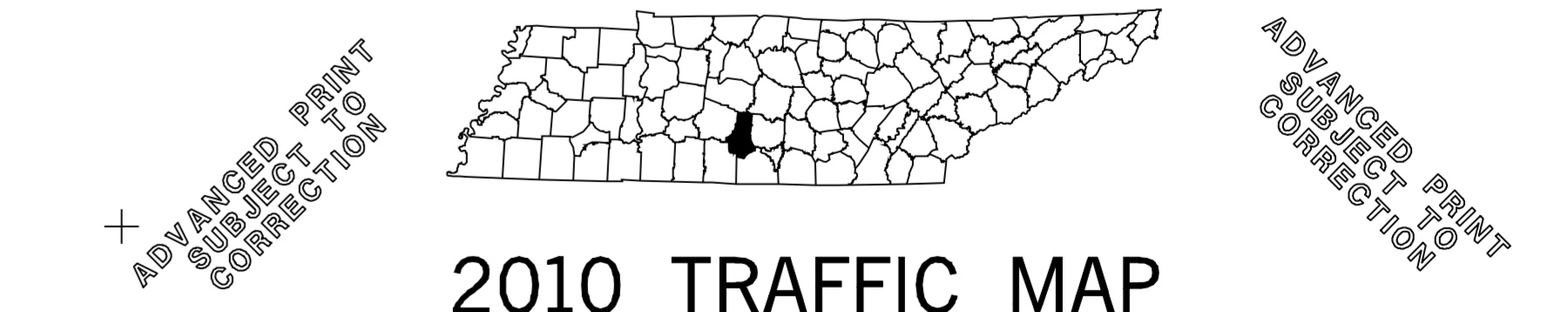

2010 TRAFFIC MAP
MARSHALL COUNTY
 TENNESSEE

PREPARED BY THE
 TENNESSEE DEPARTMENT OF TRANSPORTATION
 LONG RANGE AND PROJECT PLANNING DIVISIONS
 IN COOPERATION WITH THE
 U.S. DEPARTMENT OF TRANSPORTATION
 FEDERAL HIGHWAY ADMINISTRATION



2010

AUTHORIZATION NO. 4090975900

MAP RECORD
 FIELD DATA OBTAINED IN 1992
 FIELD EXAMINATION MADE IN 1997

REVISIONS	DATE
FEATURE	

1 COUNTY MAP SHEET WITH
 4 SUPPLEMENTAL CITY MAP SHEETS
 CHAPEL HILL
 LEWISBURG
 CORNERSVILLE
 PETERSBURG

LAMBERT CONFORMAL CONIC PROJECTION
 20,000 FOOT GRID TICS BASED ON THE
 TENNESSEE COORDINATE SYSTEM
 1987 NORTH AMERICAN DATUM

POPULATION OF MARSHALL COUNTY
 24,339 1990 CENSUS

COUNTY	STATION NUMBER	YEAR	AADT
59	000001	2010	507
59	000002	2010	3351
59	000003	2010	1391
59	000004	2010	914
59	000005	2010	1008
59	000008	2010	960
59	000009	2010	4478
59	000010	2010	1176
59	000012	2010	7691
59	000013	2010	1799
59	000014	2010	502
59	000016	2010	276
59	000019	2010	350
59	000020	2010	980
59	000023	2010	2699
59	000024	2010	649
59	000027	2010	1315
59	000030	2010	5724
59	000031	2010	1633
59	000032	2010	3146
59	000033	2010	1948
59	000034	2010	7534
59	000035	2010	963
59	000036	2010	8060
59	000037	2010	1900
59	000038	2010	6645
59	000039	2010	1056
59	000040	2010	1058
59	000041	2010	889
59	000042	2010	182
59	000043	2010	946
59	000044	2010	3232
59	000046	2010	513
59	000049	2010	465
59	000050	2010	367
59	000051	2010	304
59	000052	2010	687
59	000053	2010	3261
59	000054	2010	990
59	000055	2010	5705
59	000056	2010	9182
59	000057	2010	6000
59	000058	2010	12271
59	000059	2010	9950
59	000060	2010	16241
59	000061	2010	6572
59	000062	2010	9231
59	000063	2010	21087
59	000064	2010	19781
59	000065	2010	4693
59	000066	2010	7670

59	000067	2010	14383
59	000068	2010	7200
59	000069	2010	5308
59	000070	2010	3367
59	000071	2010	4378
59	000072	2010	7180
59	000073	2010	911
59	000074	2010	1790
59	000075	2010	1097
59	000076	2010	4097
59	000077	2010	1217
59	000078	2010	5057
59	000080	2010	764
59	000081	2010	939
59	000082	2010	1820
59	000084	2010	455
59	000085	2010	3241
59	000086	2010	161
59	000087	2010	365
59	000088	2010	400
59	000089	2010	255
59	000090	2010	717
59	000091	2010	1715
59	000092	2010	323
59	000093	2010	1167
59	000094	2010	1805
59	000095	2010	3882
59	000096	2010	707
59	000097	2010	132
59	000098	2010	674
59	000099	2010	1670
59	000100	2010	2695
59	000101	2010	2925
59	000105	2010	3880
59	000106	2010	1397
59	000107	2010	493
59	000108	2010	689
59	000110	2010	765
59	000111	2010	2510
59	000112	2010	7879
59	000113	2010	632
59	000114	2010	1361
59	000115	2010	1278
59	000116	2010	2187
59	000117	2010	1988
59	000118	2010	1127
59	000119	2010	680
59	000120	2010	4683
59	000122	2010	717
59	000123	2010	9356
59	000124	2010	12000
59	000125	2010	16057

59	000126	2010	2805
59	000127	2010	1269
59	000129	2010	251
59	000130	2010	459
59	000131	2010	6681
59	000132	2010	5867
59	000133	2010	579