

SCALE OF INSETS
0 0.1 0.2 0.3 0.4 0.5 MILES

- LEGEND**
- SCHOOL
 - CHURCH WITH CEMETERY
 - CEMETERY
 - HOSPITAL
 - POST OFFICE
 - CITY HALL OR COMMUNITY CENTER
 - MONUMENT
 - AIRPORT - COMPLETE FACILITIES
 - AIRPORT - LIMITED FACILITIES
 - LANDING AREA OR STRIP
 - HIGHWAY GARAGE (IS-STATE, C-COUNTY)
 - TRIANGULATION STATION
 - OBSERVATION OR LOOKOUT TOWER
 - COUNTY SEAT
 - OTHER CITIES AND VILLAGES
 - RADIO OR TELEVISION STATION
 - POINT OF INTEREST
 - DOT TO INDICATE LOCATION OF ANY CULTURAL FEATURE OUT OF PLACE
 - INTERSTATE HIGHWAY
 - U S NUMBERED HIGHWAY
 - STATE HIGHWAY
 - PROMINENT PEAK WITH ELEVATION
 - LAKE WITH DAM
 - RESERVOIR - POND OR LAKE
 - LEVEE OR DYKE
 - DRAINAGE CANAL
 - NARROW STREAM
 - WIDE STREAM
 - DAM WITH LOCK
 - HEAD OF NAVIGATION
 - NAVIGABLE STREAM
 - GRADE CROSSING
 - UNDERPASS-ROAD BELOW
 - OVERHEAD-ROAD ABOVE
 - RAILROAD TUNNEL
 - GRADE SEPARATION
 - FORD
 - LOW WATER BRIDGE
 - FREE FERRY OR TOLL FERRY
 - HIGHWAY BRIDGE-OVER 20 FEET
 - HIGHWAY BRIDGE-LONG RIVER CROSSING
 - PRIMITIVE OR UNIMPROVED ROAD
 - GRADED AND DRAINED SOIL GRAVEL OR STONE SURFACED ROAD
 - PAVED ROAD
 - PAVED HIGHWAY OR ROAD
 - DIVIDED ROADWAY
 - DISTANCE IN MILES BETWEEN DESIGNATED POINTS
 - FULL CONTROL OF ACCESS
 - NATIONAL PARK SERVICE HIGHWAY
 - HIGHWAY INTERCHANGE
 - COUNTY LINE
 - STATE LINE
 - INCORPORATED CITY BOUNDARY
 - RESERVATION BOUNDARY

LEGEND
 STATION NUMBER ● 143
 A. A. D. T.
 (ANNUAL AVERAGE DAILY TRAFFIC)
NOTES
 HIGHEST STATION NUMBER FOR THIS COUNTY - 218

STATION NUMBERS ON WILLIAMSON COUNTY MAP
 3-4-5-6-7-8-9-10-11-14-15-16-19-20-21-22-24-26-36-37-38-39
 49-51-52-53-54-55-56-57-58-59-60-61-62-63-64-65-66-67-68
 69-70-72-73-74-76-77-78-79-80-82-83-84-85-92-93-94-95-98
 99-100-101-102-103-109-110-115-116-117-120-122-123-126-127
 129-131-132-133-134-135-136-137-138-161-162-163-166-167-184
 185-186-187-198-199-200-201-202-204-210-211-213-214-215

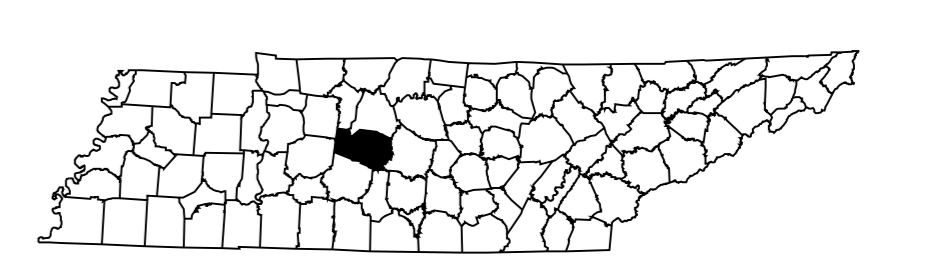

ADVANCED PRINT SUBJECT TO CORRECTION

2010 TRAFFIC MAP WILLIAMSON COUNTY TENNESSEE

PREPARED BY THE
 TENNESSEE DEPARTMENT OF TRANSPORTATION
 LONG RANGE AND PROJECT PLANNING DIVISIONS
 IN COOPERATION WITH THE
 U.S. DEPARTMENT OF TRANSPORTATION
 FEDERAL HIGHWAY ADMINISTRATION

SCALE
 0 1 2 3 4 MILES
 2010

MAP RECORD
 FIELD DATA OBTAINED IN 1993
 FIELD EXAMINATION MADE IN 1996

| REVISIONS | DATE |
|----------------------|------|
| STATE HIGHWAY SYSTEM | 2008 |
| | |
| | |
| | |

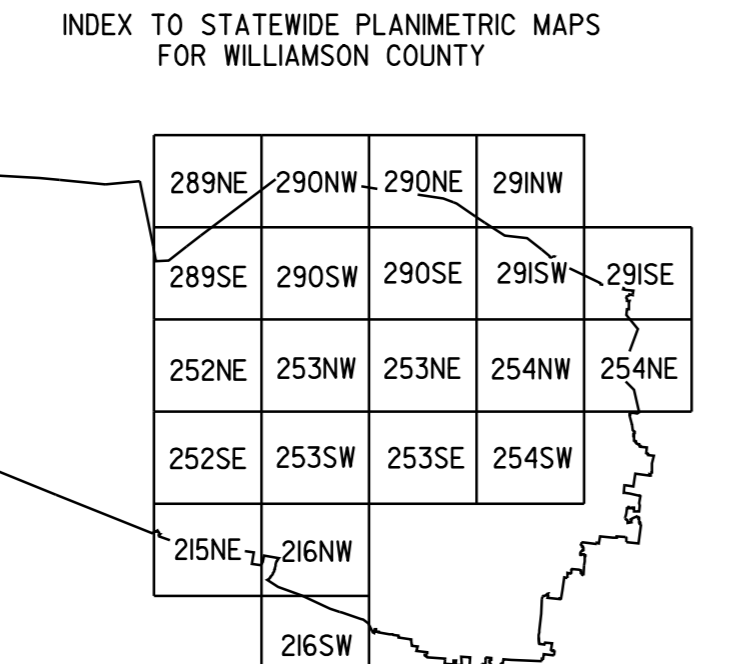

1 COUNTY MAP SHEET WITH 21 STATEWIDE PLANIMETRIC MAP SHEETS AND 1 SUPPLEMENTAL CITY MAP SHEET
 FAIRVIEW

POPULATION OF WILLIAMSON COUNTY
 126,838 (2000 CENSUS)

LAMBERT CONFORMAL CONIC PROJECTION
 20,000 FOOT GRID TIEKS BASED ON THE TENNESSEE COORDINATE SYSTEM (WEST NORTH AMERICAN DATUM)

| COUNTY | STATION NUMBER | YEAR | AADT |
|--------|----------------|------|-------|
| 94 | 000001 | 2010 | 9335 |
| 94 | 000002 | 2010 | 24825 |
| 94 | 000003 | 2010 | 9605 |
| 94 | 000004 | 2010 | 19150 |
| 94 | 000005 | 2010 | 4060 |
| 94 | 000006 | 2010 | 938 |
| 94 | 000007 | 2010 | 781 |
| 94 | 000008 | 2010 | 12561 |
| 94 | 000009 | 2010 | 727 |
| 94 | 000010 | 2010 | 7180 |
| 94 | 000011 | 2010 | 2758 |
| 94 | 000014 | 2010 | 1220 |
| 94 | 000015 | 2010 | 4995 |
| 94 | 000016 | 2010 | 1715 |
| 94 | 000019 | 2010 | 640 |
| 94 | 000020 | 2010 | 1522 |
| 94 | 000021 | 2010 | 2368 |
| 94 | 000022 | 2010 | 384 |
| 94 | 000024 | 2010 | 2699 |
| 94 | 000026 | 2010 | 3914 |
| 94 | 000027 | 2010 | 7746 |
| 94 | 000028 | 2010 | 3430 |
| 94 | 000029 | 2010 | 3239 |
| 94 | 000030 | 2010 | 16809 |
| 94 | 000031 | 2010 | 14737 |
| 94 | 000032 | 2010 | 6994 |
| 94 | 000033 | 2010 | 20370 |
| 94 | 000034 | 2010 | 6250 |
| 94 | 000035 | 2010 | 21992 |
| 94 | 000036 | 2010 | 3161 |
| 94 | 000037 | 2010 | 9001 |
| 94 | 000038 | 2010 | 4305 |
| 94 | 000039 | 2010 | 14160 |
| 94 | 000040 | 2010 | 22312 |
| 94 | 000041 | 2010 | 2891 |
| 94 | 000042 | 2010 | 16620 |
| 94 | 000043 | 2010 | 21957 |
| 94 | 000044 | 2010 | 21432 |
| 94 | 000045 | 2010 | 5550 |
| 94 | 000046 | 2010 | 5140 |
| 94 | 000048 | 2010 | 3295 |
| 94 | 000049 | 2010 | 2442 |
| 94 | 000051 | 2010 | 10495 |
| 94 | 000052 | 2010 | 4870 |
| 94 | 000053 | 2010 | 1646 |
| 94 | 000054 | 2010 | 5092 |
| 94 | 000055 | 2010 | 6189 |
| 94 | 000056 | 2010 | 10465 |
| 94 | 000057 | 2010 | 6928 |
| 94 | 000058 | 2010 | 4114 |
| 94 | 000059 | 2010 | 1393 |

| | | | |
|----|--------|------|--------|
| 94 | 000060 | 2010 | 518 |
| 94 | 000061 | 2010 | 965 |
| 94 | 000062 | 2010 | 1625 |
| 94 | 000063 | 2010 | 3094 |
| 94 | 000064 | 2010 | 1525 |
| 94 | 000065 | 2010 | 4780 |
| 94 | 000066 | 2010 | 2557 |
| 94 | 000067 | 2010 | 17900 |
| 94 | 000068 | 2010 | 2412 |
| 94 | 000069 | 2010 | 1534 |
| 94 | 000070 | 2010 | 3843 |
| 94 | 000072 | 2010 | 3296 |
| 94 | 000073 | 2010 | 1574 |
| 94 | 000074 | 2010 | 532 |
| 94 | 000076 | 2010 | 1195 |
| 94 | 000077 | 2010 | 3419 |
| 94 | 000078 | 2010 | 390 |
| 94 | 000079 | 2010 | 69320 |
| 94 | 000080 | 2010 | 62476 |
| 94 | 000081 | 2010 | 135428 |
| 94 | 000082 | 2010 | 1659 |
| 94 | 000083 | 2010 | 5924 |
| 94 | 000084 | 2010 | 12125 |
| 94 | 000085 | 2010 | 1161 |
| 94 | 000086 | 2010 | 7808 |
| 94 | 000087 | 2010 | 18010 |
| 94 | 000088 | 2010 | 16881 |
| 94 | 000089 | 2010 | 18312 |
| 94 | 000090 | 2010 | 18852 |
| 94 | 000092 | 2010 | 7826 |
| 94 | 000093 | 2010 | 1195 |
| 94 | 000094 | 2010 | 11976 |
| 94 | 000095 | 2010 | 4411 |
| 94 | 000096 | 2010 | 27021 |
| 94 | 000097 | 2010 | 16947 |
| 94 | 000098 | 2010 | 14715 |
| 94 | 000099 | 2010 | 1364 |
| 94 | 000100 | 2010 | 4305 |
| 94 | 000101 | 2010 | 2622 |
| 94 | 000102 | 2010 | 8582 |
| 94 | 000103 | 2010 | 4161 |
| 94 | 000104 | 2010 | 10021 |
| 94 | 000105 | 2010 | 20591 |
| 94 | 000106 | 2010 | 11540 |
| 94 | 000107 | 2010 | 10037 |
| 94 | 000108 | 2010 | 6664 |
| 94 | 000109 | 2010 | 3348 |
| 94 | 000110 | 2010 | 864 |
| 94 | 000111 | 2010 | 9230 |
| 94 | 000112 | 2010 | 8422 |
| 94 | 000113 | 2010 | 2814 |
| 94 | 000114 | 2010 | 5841 |

| | | | |
|----|--------|------|--------|
| 94 | 000115 | 2010 | 5845 |
| 94 | 000116 | 2010 | 2705 |
| 94 | 000117 | 2010 | 781 |
| 94 | 000119 | 2010 | 14562 |
| 94 | 000120 | 2010 | 570 |
| 94 | 000121 | 2010 | 10231 |
| 94 | 000122 | 2010 | 457 |
| 94 | 000123 | 2010 | 142 |
| 94 | 000124 | 2010 | 2130 |
| 94 | 000126 | 2010 | 5428 |
| 94 | 000127 | 2010 | 6500 |
| 94 | 000129 | 2010 | 9145 |
| 94 | 000131 | 2010 | 112226 |
| 94 | 000132 | 2010 | 18821 |
| 94 | 000133 | 2010 | 1512 |
| 94 | 000134 | 2010 | 370 |
| 94 | 000135 | 2010 | 354 |
| 94 | 000136 | 2010 | 1442 |
| 94 | 000137 | 2010 | 718 |
| 94 | 000138 | 2010 | 1842 |
| 94 | 000139 | 2010 | 28525 |
| 94 | 000140 | 2010 | 10319 |
| 94 | 000141 | 2010 | 6086 |
| 94 | 000142 | 2010 | 18967 |
| 94 | 000143 | 2010 | 2862 |
| 94 | 000144 | 2010 | 23489 |
| 94 | 000145 | 2010 | 1241 |
| 94 | 000146 | 2010 | 1899 |
| 94 | 000147 | 2010 | 2137 |
| 94 | 000148 | 2010 | 3555 |
| 94 | 000149 | 2010 | 2174 |
| 94 | 000150 | 2010 | 4513 |
| 94 | 000151 | 2010 | 5727 |
| 94 | 000152 | 2010 | 2451 |
| 94 | 000153 | 2010 | 5731 |
| 94 | 000154 | 2010 | 2695 |
| 94 | 000155 | 2010 | 2887 |
| 94 | 000156 | 2010 | 4799 |
| 94 | 000157 | 2010 | 134607 |
| 94 | 000158 | 2010 | 14183 |
| 94 | 000159 | 2010 | 20548 |
| 94 | 000160 | 2010 | 16270 |
| 94 | 000161 | 2010 | 97790 |
| 94 | 000162 | 2010 | 27142 |
| 94 | 000163 | 2010 | 462 |
| 94 | 000164 | 2010 | 19324 |
| 94 | 000165 | 2010 | 13090 |
| 94 | 000166 | 2010 | 699 |
| 94 | 000167 | 2010 | 687 |
| 94 | 000168 | 2010 | 6168 |
| 94 | 000169 | 2010 | 14503 |
| 94 | 000170 | 2010 | 8185 |

| | | | |
|----|--------|------|-------|
| 94 | 000171 | 2010 | 4606 |
| 94 | 000172 | 2010 | 6558 |
| 94 | 000173 | 2010 | 2068 |
| 94 | 000174 | 2010 | 914 |
| 94 | 000175 | 2010 | 2774 |
| 94 | 000176 | 2010 | 22502 |
| 94 | 000177 | 2010 | 6127 |
| 94 | 000178 | 2010 | 1576 |
| 94 | 000179 | 2010 | 15621 |
| 94 | 000180 | 2010 | 6943 |
| 94 | 000181 | 2010 | 6653 |
| 94 | 000182 | 2010 | 10625 |
| 94 | 000183 | 2010 | 22246 |
| 94 | 000184 | 2010 | 468 |
| 94 | 000185 | 2010 | 565 |
| 94 | 000186 | 2010 | 16873 |
| 94 | 000187 | 2010 | 9652 |
| 94 | 000188 | 2010 | 11829 |
| 94 | 000189 | 2010 | 822 |
| 94 | 000190 | 2010 | 29033 |
| 94 | 000191 | 2010 | 30008 |
| 94 | 000192 | 2010 | 3022 |
| 94 | 000193 | 2010 | 5041 |
| 94 | 000194 | 2010 | 10404 |
| 94 | 000195 | 2010 | 14297 |
| 94 | 000196 | 2010 | 9873 |
| 94 | 000197 | 2010 | 14384 |
| 94 | 000198 | 2010 | 18563 |
| 94 | 000199 | 2010 | 19679 |
| 94 | 000200 | 2010 | 18306 |
| 94 | 000201 | 2010 | 14800 |
| 94 | 000202 | 2010 | 56590 |
| 94 | 000203 | 2010 | 8415 |
| 94 | 000204 | 2010 | 1729 |
| 94 | 000205 | 2010 | 22514 |
| 94 | 000206 | 2010 | 10013 |
| 94 | 000207 | 2010 | 19504 |
| 94 | 000208 | 2010 | 2677 |
| 94 | 000209 | 2010 | 7444 |
| 94 | 000210 | 2010 | 10002 |
| 94 | 000211 | 2010 | 1700 |
| 94 | 000213 | 2010 | 323 |
| 94 | 000214 | 2010 | 663 |
| 94 | 000215 | 2010 | 4622 |
| 94 | 000216 | 2010 | 2690 |
| 94 | 000217 | 2010 | 4279 |
| 94 | 000218 | 2010 | 94209 |